

TRANSPORT POSITION

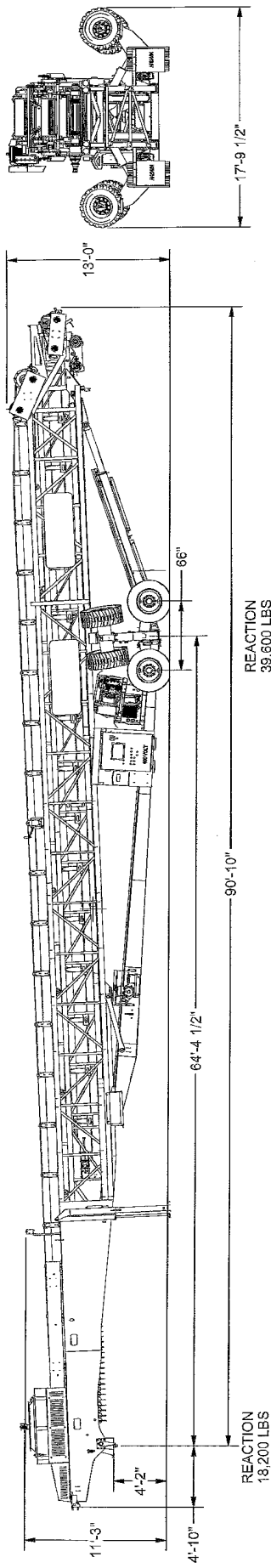

38 X 150 LPFA STOCKPILE CAPACITY  
 90° ARC - 34,250 YARDS, 46,200 TONS  
 180° ARC - 61,000 YARDS, 82,400 TONS  
 270° ARC - 87,800 YARDS, 118,500 TONS

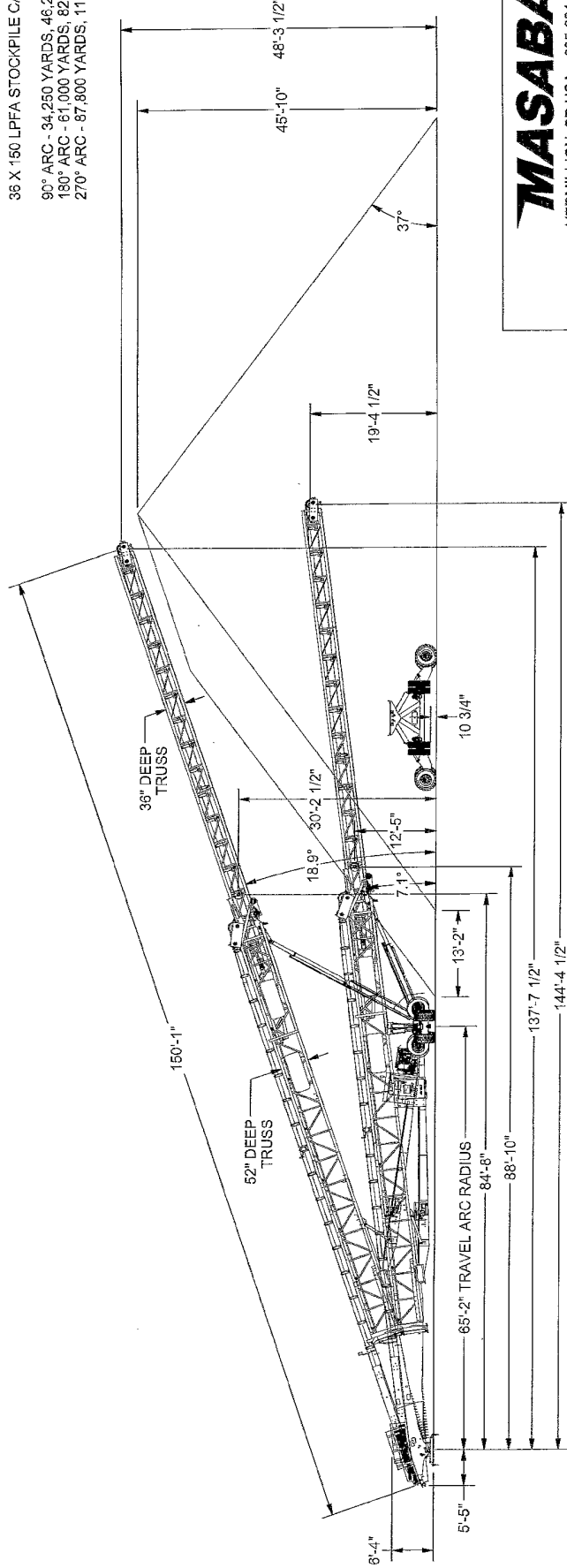

REACTION  
22,000 LBS MAX

REACTION  
60,000 LBS MAX

OPERATING POSITION

**MASABA**  
 VERMILLION, SD USA 605-624-9555

DESCRIPTION		36X150LPFA MAGNUM BASE UNIT	
DESIGNED BY	ADP	WEIGHT	N/A
DRAWN BY	ADP	DATE	9/11/2019
SCALE	3/32" = 1"	PART NUMBER	90000007
		SIZE	B
		SHEET	/ 1
		REV	
			000

THIS DRAWING IS THE PROPERTY OF MASABA AND SHALL NOT BE REPRODUCED, COPIED, OR DISCLOSED WITHOUT AUTHORIZED PERMISSION FROM MASABA. THIS DOCUMENT IS TO BE RETURNED UPON REQUEST. DIMENSIONAL TOLERANCES: .118"

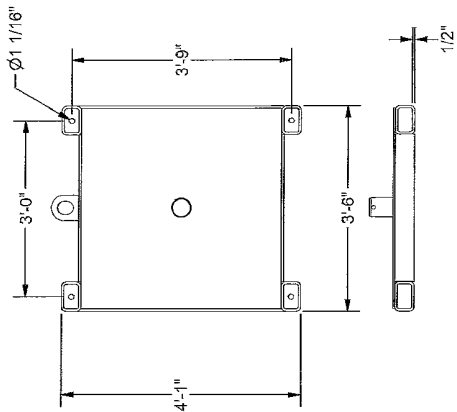

STANDARD PIVOT PLATE

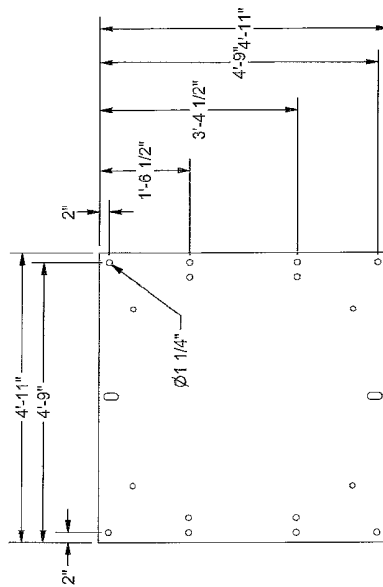

OPTIONAL PIVOT PLATE

1 1/4" PLATE THICKNESS

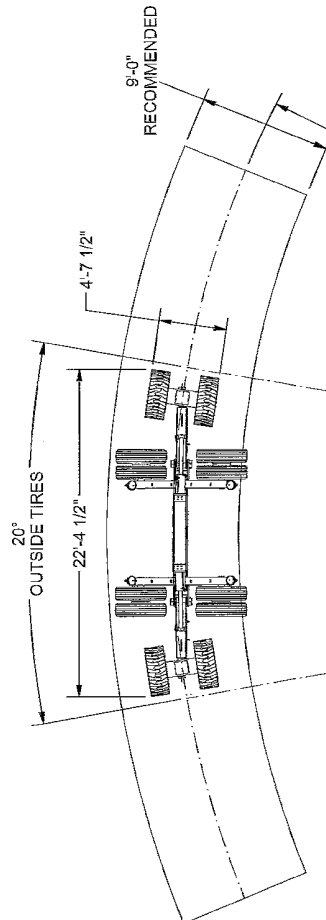

R65'-2"  
CENTER OF ARC

ARC PAD SHOULD BE THE SAME ELEVATION AS PIVOT PAD

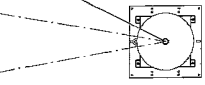

**MASABA**  
VERMILLION, SD USA 605-624-9555

DESCRIPTION	36X150L PFA MAGNUM BASE UNIT		
DESIGNED BY	ADS	WEIGHT	N/A
DRAWN BY	ADS	DATE	9/11/2019
SCALE	3/32" = 1'	PART NUMBER	90000007
		SIZE	B
		SHEET	/ 1
		REV	000

THIS DRAWING IS THE CONFIDENTIAL PROPERTY OF MASABA, AND SHALL NOT BE COPIED, REPRODUCED OR DISCLOSED WITHOUT AUTHORIZED PERMISSION FROM MASABA. THIS DOCUMENT IS TO BE USED ONLY FOR THE INTENTED DIMENSIONAL TOLERANCES: ±1/16"